



CROW WING
Soil & Water
CONSERVATION DISTRICT

2023 SWCD Newsletter

***Save the Date
TREE SALE
OPEN HOUSE
January 6, 2023**

Open House: 9am-1pm
322 Laurel Street Brainerd, MN



2022 Outstanding Conservationist Award
Kristie Roedl

2023 Plat Books
Coming April 2023
www.cwswcd.org/shop

Grants: Limited Funding Available!

- Rain Gardens
- Erosion Control
- Forest Stewardship Plans
- Buffer strips on a field or lakeshore
- Conservation Easements
- Shoreline Restoration
- Rain Barrels with another Practice
- Forest Planting 



2023
SWCD Staff:
Andrew, Tasha,
Bethany,
Melissa, Adam

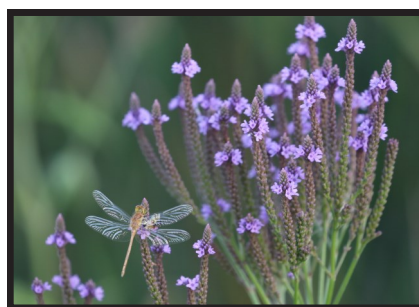

2022 Native Plant
Photo Contest
1st Place Winner

"Blue Vervain
with Dragonfly
by
Courtney Neifert"

***OPEN HOUSE: Friday, January 6th, 2023**
9-1 pm \$10 off orders of \$100 or more at Open House

Speakers: Mike North, MN DNR: How long does it take Aspen to attain sizes for use in wildlife. John Latimer, KAXE: Phenology

Crow Wing County Land Services: Meeting Rooms 1 & 2

NOW ACCEPTING TREE SALE ORDERS:

January 1st, 2022 - February 20th, 2023: or until sold out, limited quantities.

ORDER EARLY!

3 WAYS TO ORDER

1. Online www.cwswcd.org/shop
2. Call 218-828-6197
3. Mail/Office: 322 Laurel Street, Ste. 22, Brainerd, MN 56401

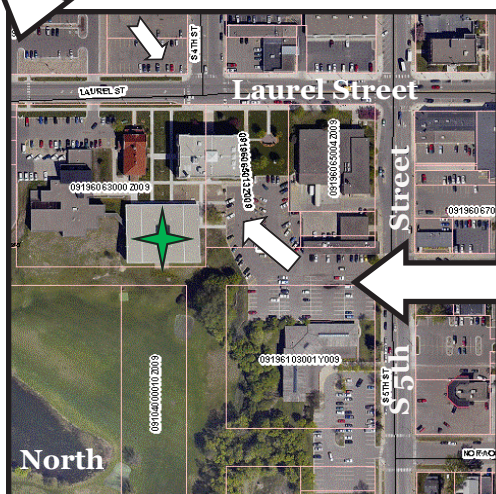

 Office Location  Parking



**TREE & PLANT
PICK UP/
CWC Fairgrounds,
Curling Building
13th Street/CR 45,
Brainerd, MN**

**Thursday, May 11th:
8 am to 5 pm
Friday, May 12th:
8 am to 5 pm**

Crow Wing SWCD 322 Laurel Street, Suite 22, Brainerd, MN

E-mail: tasha@cwswcd.org Phone: 218-828-6197

Facebook: www.facebook.com/cwswcd Web: www.cwswcd.org



Crow Wing SWCD
322 Laurel St. Suite 22
Brainerd, MN 56401
218-828-6197

2023 Tree Sale Order Form Inside

Rick Kramer has lived on his property in Brainerd, MN for the last 70 years. He built a home on 2.5 acres in 1978 and purchased an adjacent 40 acres ten years later. With the new land purchase, he decided to have a Forest Stewardship Plan written for his property. Rick and his wife Marsha have been an admirable example of land stewardship ever since. In 1991, they conducted a 40 acre timber harvest followed by planting 4,000 red pine and 1,000 white spruce. In 1997, Rick inherited an additional 32.5 acres from his parents and planted crabapple trees, apple trees, and highbush cranberry. They have kept their Forest Stewardship Plan up to date by renewing it every 10 years.

After the last renewal of their Forest Stewardship Plan in 2018, they followed the advice of their forester to harvest timber off 40 acres to remove diseased trees, blow down, and thin the red pine stand. After the harvest they utilized DNR cost share to plant and protect 1,000 bur oaks, bud cap, and begin the fight to control invasive buckthorn.

In 2022, Rick inquired with Crow Wing SWCD about cost share opportunities for a prescribed grazing project to utilize goats to help manage buckthorn on the property. Crow Wing SWCD staff worked with the Natural Resource Conservation Service and the contractor, Brainerd Lakes Goats, to devise a plan to have a herd of approximately 40 goats grazing 35 acres from May to October. Goats defoliate buckthorn and fully digest berries of the plant; this forces buckthorn to expend energy trying to regenerate leaves and prevents the buckthorn seeds from reaching the soil.

Rick and Marsha were even gracious enough to allow Crow Wing SWCD to highlight the project for the Area VIII SWCD Tour, opening the property to a bus load of people to view the work. This project served as a great educational tool for staff to see the impact and uses of goat grazing (see the difference between grazed and ungrazed paddocks in the headline image). A sentiment that Crow Wing SWCD can echo, Rick stated “I was very impressed with the work the goats did and the commitment of the owner, Joe.”

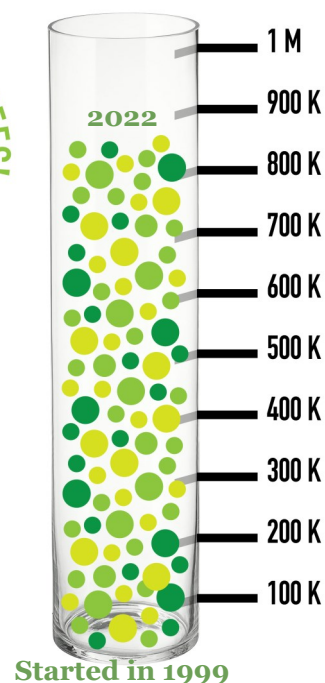

Do you want help with your woods?

Funds are available to assist you with woodland projects, including a site specific plan that tells what types of trees and habitats you have.

Tree Planter is available for rent at \$100/day + \$100 deposit.

Email or call Andrew@cswgcd.org 218-828-6197



Crow Wing SWCD 322 Laurel Street, Suite 22, Brainerd, MN

E-mail: tasha@cswgcd.org

Phone: 218-828-6197

Facebook: www.facebook.com/cswgcd

Web: www.cswgcd.org



2023 Tree & Plant Order Form

Online ordering and details: www.cswswcd.org

Order: January 1 - February 20, 2023 (or until sold out)

Name						Phone			
Mailing Address									
City						State		Zip Code	
Email Address									
<p>Each Bundle consists of 25 trees.</p> <p>Buy 10 bundles (250 trees) of a single species for \$324.</p> <p>Sizes will vary they are dependent on nursery stock.</p>									
Trees: Bare Root	Growth Rate	Soil	Size	Mature Height (ft)	Price for 25 (1)	Price for 250 (10)	# of Bundles	Total \$	
American Wild Plum (<i>Prunus americana</i>)	Medium	Dry/Moist	8-12"	15'-25'	\$36	\$324			
Bur Oak (<i>Quercus macrocarpa</i>)	Slow	Dry/Moist	5-12"	65-85'	\$36	\$324			
Crabapple, Red Splendor (<i>Malus 'Red splendor'</i>) *	Medium	Dry/Moist	12-18"	20-30'	\$36	\$324			
Jack Pine (<i>Pinus banksiana</i>)	Fast	Dry	6-14"	70-80'	\$36	\$324			
Mountain Ash (<i>Sorbus americana</i>)	Slow	Moist	12-18"	30-40'	\$36	\$324			
Paper Birch (<i>Betula papyrifera</i>)	Fast	Dry/Moist	12-18"	50-70'	\$36	\$324			
Red Maple (<i>Acer rubrum</i>)	Fast	Moist	9-12"	45-65'	\$36	\$324			
Red Oak (<i>Quercus rubra</i>)	Medium	Dry/Moist	5-12"	50-75'	\$36	\$324			
Red Pine (Norway) (<i>Pinus resinosa</i>)	Fast	Dry/Moist	5-12"	50-80'	\$36	\$324			
Smooth Sumac (<i>Rhus glabra</i>)	Fast	Moist	12-24"	12-24'	\$36	\$324			
White Pine (<i>Pinus strobus</i>)	Medium	Dry/Moist	5-12"	80-100'	\$36	\$324			
White Spruce (<i>Picea glauca</i>)	Medium	Dry/Moist	5-12"	40-80'	\$36	\$324			
* Native Cultivar: Derived from more than one native plant.									
Shrubs: Bare Root	Growth Rate	Soil	Size	Mature Height (ft.)	Price for 25 (1)	Price for 250 (10)	# of Bundles	Total \$	
Black Cherry (<i>Prunus serotina</i>)	Fast	Dry/Moist	12-18"	50'-75'	\$36	\$324			
Black Chokeberry (<i>Aronia melanocarpa</i>)	Medium	Dry/Moist	12-18"	3'-6'	\$36	\$324			
Common Chokecherry (<i>Prunus virginiana</i>)	Medium	Dry/Moist	8-12"	20-30'	\$36	\$324			
Common Ninebark (<i>Physocarpus opulifolius</i>)	Fast	Dry/ Wet	12-18"	6'-12'	\$36	\$324			
Elderberry (<i>Sambucus canadensis</i>)	Fast	Moist/ Wet	12-18"	5'-12'	\$36	\$324			
False Indigo (<i>Amorpha fruticosa</i>)	Medium	Dry/Moist	12-18"	6'-9'	\$36	\$324			
Highbush Cranberry (<i>Viburnum trilobum</i>)	Medium	Moist	12-18"	8-12'	\$36	\$324			
Nannyberry (<i>Viburnum lentago</i>)	Fast	Moist/ Wet	12-18"	7'-16'	\$36	\$324			
Red Osier Dogwood (<i>Cornus sericea</i>)	Fast	Dry/Moist	8-12"	5'-10'	\$36	\$324			
Sand Cherry (<i>Prunus pumila</i>)	Slow	Dry/Wet	12-18"	4'-6'	\$36	\$324			
Serviceberry (<i>Amelanchier alnifolia</i>)	Medium	Dry/Moist	8-12"	6'-9'	\$36	\$324			
Other Items							# of items	Total \$	
Tree Tubes & Stakes: 3' Mesh Tubes/4' Bamboo Stakes			\$35.00/Bundle of 25						
Natural Weed Suppressant Mat (Aspen Fibers): 5' x 50'			\$125 each						
Tree Planting Bar: \$60 Refund Issued Upon Rental Return			RENT: \$65 each # _____		BUY: \$65 each # _____				
Tree Planter: 20" Coulter with Trailer			\$100/day plus \$100 Damage Deposit						

2023 Tree & Plant Order Form

Plants: Plug Kits*		\$ Per Kit*	# of Kits	Total \$		
Monarch Special	Includes milkweed species for the caterpillars to feast on and other blooming species for nectar. Plant anywhere with lots of sun.	\$70.00				
Rain Garden	Consider planting at the edge of parking lots, driveways, and any other areas with concentrated runoff.	\$70.00				
Shade Garden	Plant in areas of partial to majority shade, filtered sunlight, or limited hours of direct sunlight.	\$70.00				
Shoreline Stabilization	A collection of deep-rooted aquatic plants while creating habitat for a wide range of wetland creatures and spawning grounds for a variety of fish.	\$70.00				
Buckthorn Replacement	A collection of plants you can strategically use to help out-compete future buckthorn seedlings and reduce the chances of the infestation returning.	\$70.00				
*Kits 36 plants; six plants of six different species. Species included will vary based on current inventory and availability in a variety of bloom times and blossom colors. Plant in 40 – 60 square foot area.						
Seeds: Mixes		Mature Height (ft)	Area (sq ft)	\$ Per Pkg	# of Pkgs	Total \$
Lakeshore	Attractive mix with moisture-tolerant and emergent species that thrive near the water’s edge. Shorter height grasses, sedges, and wildflowers.	2’-3’	1,000	\$100.00		
Pollinator	The most diverse mix for pollinators. Grasses, sedges, and over 25 wildflower species. Best for dry to mesic soil conditions.	2’-3’	100	\$25.00		
Savanna	Designed for part-sun oak savanna and woodland edge sites with 25-50% tree cover.	2’-4’	1,000	\$65.00		
Septic Mound	Designed with great species for poor-soil septic mound and drainfield areas.	1’-3’	1,000	\$65.00		
Songbird	Designed to improve forage and habitat for MN native songbirds. Best for dry to mesic soils.	2’-5’	100	\$25.00		
Upland Dry Prairie Shortgrass	Designed for dry, well-drained sites or sandy soils.	2’-3’	5,000	\$140.00		
Wet Prairie	Mixed height prairie mix for wet but not heavily saturated soils.	3’-6’	500	\$55.00		
Woodland	Includes a variety of native grass, sedge, and wildflower species suited for moderate to dense shade.	1’-5’	500	\$75.00		
Onsite Visit				Total \$		
Onsite Visit by an SWCD Technician includes advice for your property, native vegetation, tree planting, erosion, and stormwater issues. Request Onsite Visit here: https://www.cwsxcd.org/requestanonsitevisit				\$125.00		
Ordering Instructions		>>> Sales tax already included in price <<< *Orders less than \$100: Payment required in full. *Orders over \$100: Require 50% down payment.				
Online: https://www.cwsxcd.org/shop Mail or In Person: Crow Wing SWCD, 322 Laurel Street, Suite 22, Brainerd, MN 56401 Will accept cash, credit, or check. Make checks payable to Crow Wing SWCD.		Technical On-Site Visit			\$	
		Tax Exempt (Must Provide ST3 Form)			\$	
		Total Due			\$	
Pick Up Instructions		Check, Credit, or Cash				
Location: Crow Wing County Fairgrounds Curling Building 2000 SE 13 th St, Brainerd, MN 56401 Dates: Thursday May 11 th from 8 am to 5 pm and Friday May 12 th from 8 am to 5 pm Extras: Limited number of extras will be available for purchase Friday at noon in bundles of 25 For better planting success, please plant within 2-3 days of pick up! Refunds: Until February 20, 2023, with a \$20 stocking fee. No Refunds after February 20, 2023 Storage Fee for Late Pick Up: \$25 per box/bag of trees and \$25 per tray of plants. Please call 218-828-6197, for arranging to pick up your order.		Check Number				
		Date of Order				
		Balance Due			\$	
		Tree Sale Open House				
		Date: Friday, January 6th				
		Time: 9 am to 1 pm				
		Location: 322 Laurel Street, Brainerd MN 56401				
Crow Wing County Land Services in Meeting Rooms #1 and 2						
\$10 off orders of \$100 or more at Open House						